

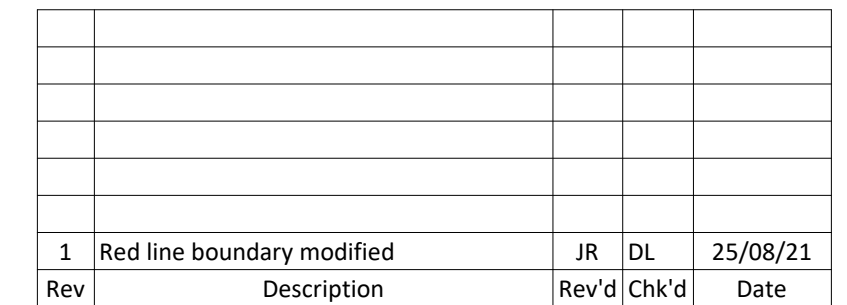

A diagram of a circle with a vertical line segment extending from the center to the top edge. The letter 'N' is positioned above the line segment.

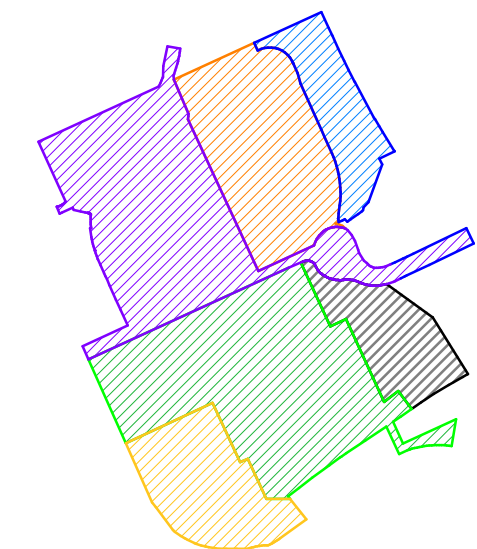

**rio**

studio@rioarchitects.com  
www.rioarchitects.com  
@rioarchitects

---

**Rio Cardiff**  
21a Allensbank Road  
Cardiff CF14 3PN  
+44 (0)29 2025 0066

**Rio London**  
19 21 Hatton Garden  
London EC1N 8BA  
+44 (0)20 2691 7565

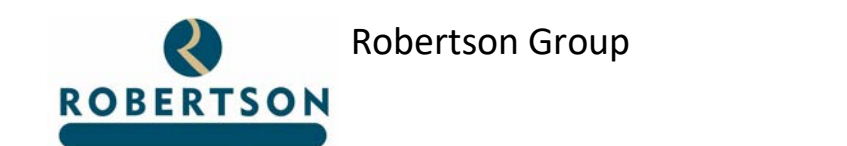

SUITABILITY :				S2		
DATE :		28/07/21		REVISION:		1
PROJECT	ORIGIN.	VOLUME	LEVEL	TYPE	DISCIP.	NUMBER
0371	RIO	XX	XX	DR	A	90512



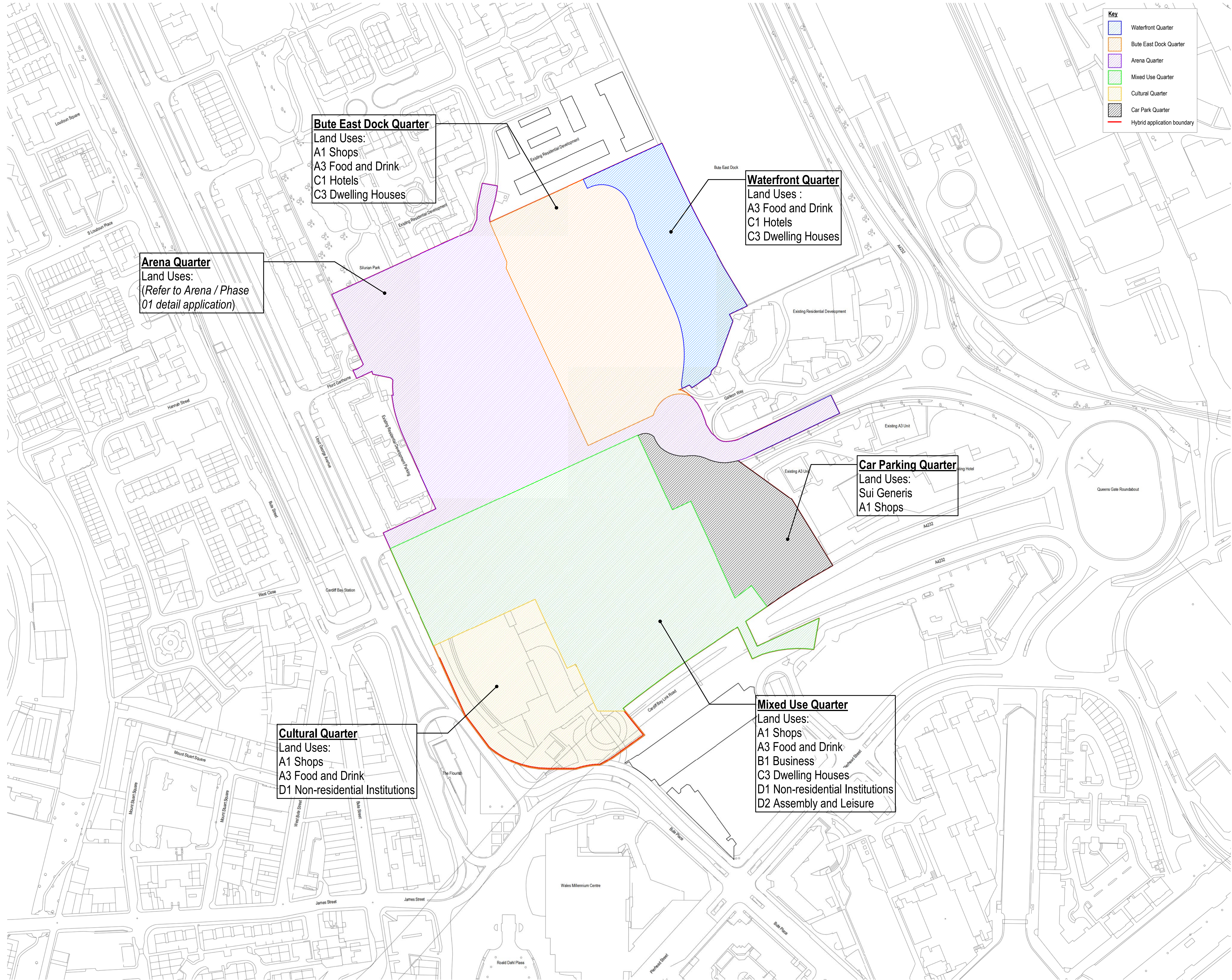

Notes:

© Rio Architects Ltd.

This drawing is copyright and must not be reproduced or disclosed to third parties without the prior written consent of Rio Architects Ltd.

Do not scale this drawing. Responsibility is not accepted by Rio Architects Ltd for errors made by others during the printing or scaling of this drawing. Use only written dimensions. It is the contractor's responsibility to verify all dimensions before commencing any work. Any discrepancies are to be notified in writing to Rio Architects Ltd immediately.

This drawing is to be read in conjunction with all other relevant project drawings, specifications and schedules prepared by Rio Architects Ltd and any other relevant consultants, specialists or subcontractors.

CDM notes are provided to assist the contractor in managing residual hazards identified during the design stage. Any such notes do not relieve the contractor of their duties under all relevant CDM Regulations.

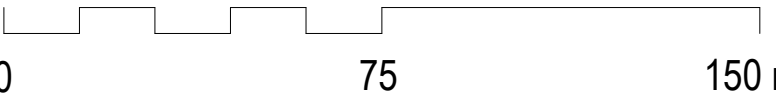
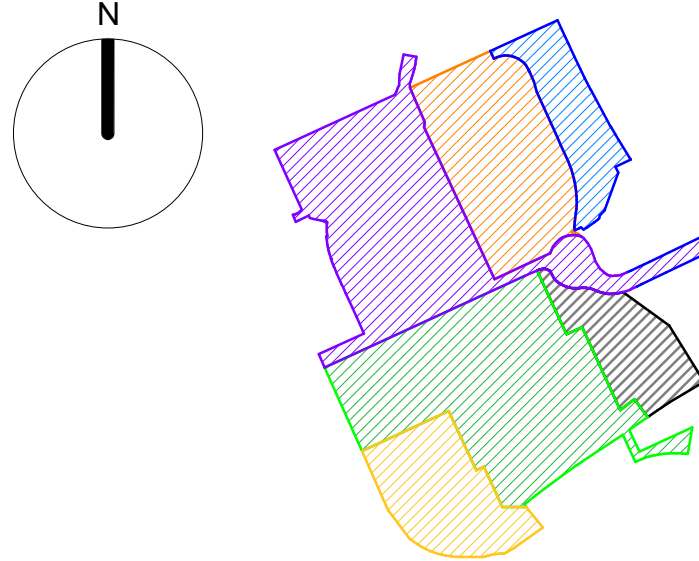

Rev	Description	Rev'd	Chk'd	Date
1	Red line boundary modified	JR	DL	25/08/21

STATUS:		PAC SUBMISSION	
SUITABILITY NUMBER KEY:			
WIP		DOCUMENTATION - SIGN-OFF	
S0 - Work in Progress**		A - Fit for construction	
SHARED		B - Fit for construction, with comments	
S1 - Fit for co-ordination**		ARCHIVE	
S2 - Fit for information		AB - As Built	
S3 - Fit for internal review and comment		FC - Final Construction	
S4 - Fit for construction approval			
DOCUMENTATION			
D1 - Fit for costing		* For internal pre-issue usage only.	
D2 - Fit for tender		** For model file usage only.	
D3 - Fit for contractor design			
D4 - Fit for manufacture/ procurement			



studio@rioarchitects.com  
www.rioarchitects.com  
@rioarchitects

**Rio Cardiff**  
21a Allensbank Road  
Cardiff CF14 3PN  
+44 (0)20 2925 0066

**Rio London**  
19 21 Hatton Garden  
London EC1N 8BA  
+44 (0)20 2691 7565



Robertson Group

PROJECT TITLE :  
Atlantic Wharf, Butetown Masterplan  
Cardiff

DRAWING TITLE :  
Land Use Parameter Plan

DRAWN BY : JR		CHECKED BY: DL		APPROVED BY : RR		
JOB NO : 0371		SCALE :		1 : 1500 @ A1		
SUITABILITY :		S2				
DATE : 28/07/21		REVISION:		1		
PROJECT	ORIGIN	VOLUME	LEVEL	TYPE	DISCIP.	NUMBER
0371	RIO	XX	XX	DR	A	90513



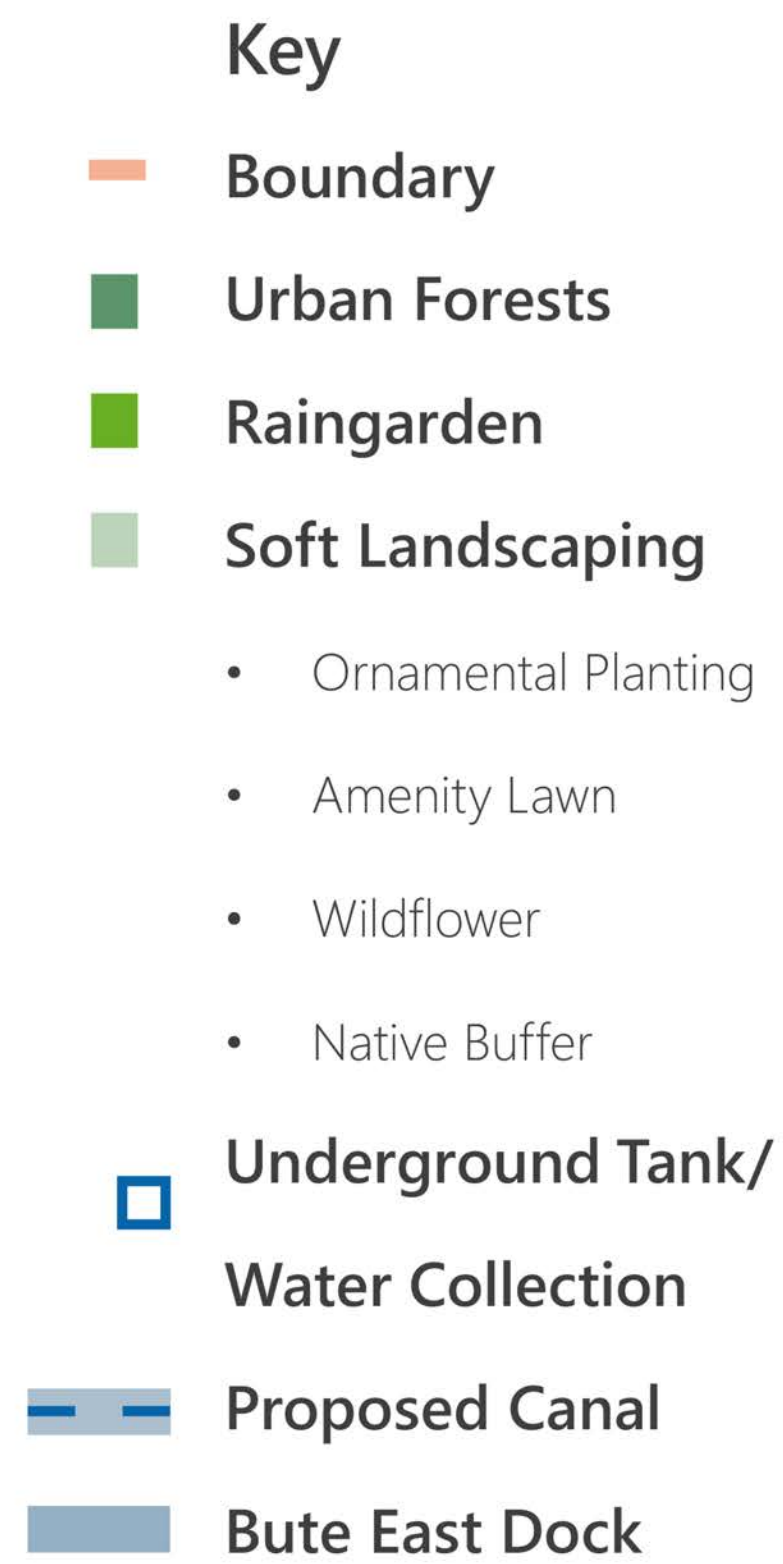

2	Red line boundary modified	JR	DL	25/08/21
1	Additional info added	KT	DL	19/08/21
Rev	Description	Rev'd	Chk'd	Date

STATUS:		PAC SUBMISSION	
<b>SUITABILITY NUMBER KEY:</b>			
<b>WIP</b>		<b>DOCUMENTATION - SIGN-OFF</b>	
50 - Work in Progress**		A - Fit for construction	
<b>SHARED</b>		B - Fit for construction, with comments	
51 - Fit for co-ordination**		<b>ARCHIVE</b>	
52 - Fit for information		AB - As Built	
53 - Fit for internal review and comment		FC - Final Construction	
54 - Fit for construction approval		<b>DOCUMENTATION</b>	
D1 - Fit for costing		* For Internal pre-issue usage only.	
D2 - Fit for tender		** For model file usage only.	
D3 - Fit for contractor design			
D4 - Fit for manufacture/procurement			

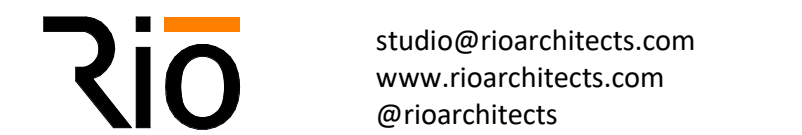

<b>Rio Cardiff</b>	<b>Rio London</b>
21a Allensbank Road	19 21 Hatton Garden
Cardiff CF14 3PN	London EC1N 8BA
+44 (0)29 2025 0066	+44 (0)20 2691 7565

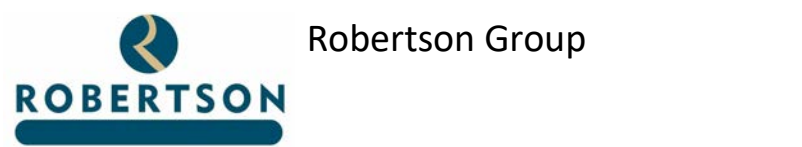

PROJECT TITLE :  
Atlantic Wharf, Butetown Masterplan  
Cardiff

DRAWING TITLE :  
Blue and Green Infrastructure Parameter  
Plan

DRAWN BY : KT      CHECKED BY: DL      APPROVED BY : RR

JOB NO : 0371	SCALE : @ A1
---------------	--------------

SUITABILITY :				S2		
DATE :		19/08/21		REVISION:		2
PROJECT	ORIGIN.	VOLUME	LEVEL	TYPE	DISCIP.	NUMBER
0371	RIO	XX	XX	DR	A	90514



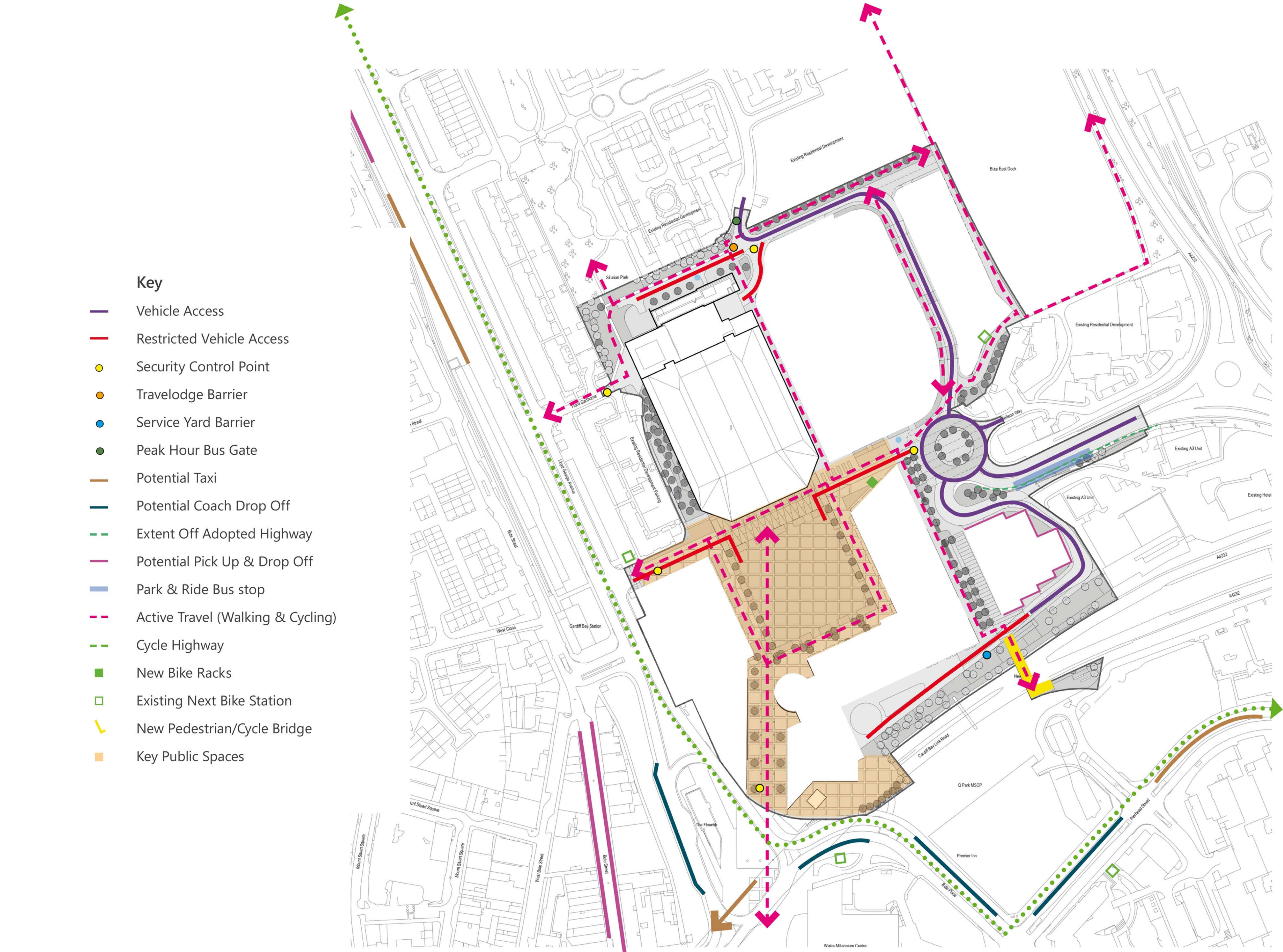

Notes:

© Rio Architects Ltd.

This drawing is copyright and must not be reproduced or disclosed to third parties without the prior written consent of Rio Architects Ltd.

Do not scale this drawing. Responsibility is not accepted by Rio Architects Ltd for errors made by others during the printing or scaling of this drawing. Use only written dimensions. It is the contractor's responsibility to verify all dimensions before commencing any work. Any discrepancies are to be notified in writing to Rio Architects Ltd immediately.

This drawing is to be read in conjunction with all other relevant project drawings, specifications and schedules prepared by Rio Architects Ltd and any other relevant consultants, specialists or subcontractors.

CDM notes are provided to assist the contractor in managing residual hazards identified during the design stage. Any such notes do not relieve the contractor of their duties under all relevant CDM Regulations.

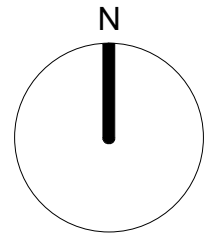

1	Red line boundary modified	JR	DL	25/08/21
Rev	Description	Rev'd	Chk'd	Date

STATUS:		PAC SUBMISSION	
SUITABILITY NUMBER KEY:			
WIP		DOCUMENTATION - SIGN-OFF	
S0 - Work in Progress*		A - Fit for construction	
SHARED		B - Fit for construction, with comments	
S1 - Fit for co-ordination**		ARCHIVE	
S2 - Fit for information		AB - As Built	
S3 - Fit for internal review and comment		FC - Final Construction	
S4 - Fit for construction approval			
DOCUMENTATION			
D1 - Fit for costing		* For internal pre-issue usage only.	
D2 - Fit for tender		** For model file usage only.	
D3 - Fit for contractor design			
D4 - Fit for manufacture/ procurement			



studio@rioarchitects.com  
www.rioarchitects.com  
@rioarchitects

**Rio Cardiff**  
21a Allensbank Road  
Cardiff CF14 3PN  
+44 (0)29 2025 0066

**Rio London**  
19 21 Hatton Garden  
London EC1N 8BA  
+44 (0)20 2691 7565



Robertson Group

PROJECT TITLE :  
Atlantic Wharf, Butetown Masterplan  
Cardiff

DRAWING TITLE :  
Access and Wayfinding Parameter Plan

DRAWN BY : KT		CHECKED BY : DJ		APPROVED BY : RR		
JOB NO : 0371		SCALE :		@ A1		
SUITABILITY :		S2				
DATE : 19/08/21		REVISION:		1		
PROJECT	ORIGIN	VOLUME	LEVEL	TYPE	DISCIP.	NUMBER
0371	RIO	XX	XX	XX	A	90515