

**Notes**

1. All dimensions are in metres unless stated otherwise. All levels are in metres above Ordnance Datum (AOD). Do not scale from this drawing.
2. The topographical survey information shown on this drawing is based on survey information provided by John Vincent Surveys Ltd, undertaken in September 2019 and additional survey areas undertaken by Gwalia Surveyors in June 2021. No responsibility is taken for the accuracy of the survey information.
3. The details shown on this drawing are based on design produced for RIBA Stage 3.
4. The proposed storm drainage design shown is subject to approval by the SAB.
5. Proposed outfall detail subject to approval by the Bute East Dock Wall owner, thought to be ABP at both outfall locations.

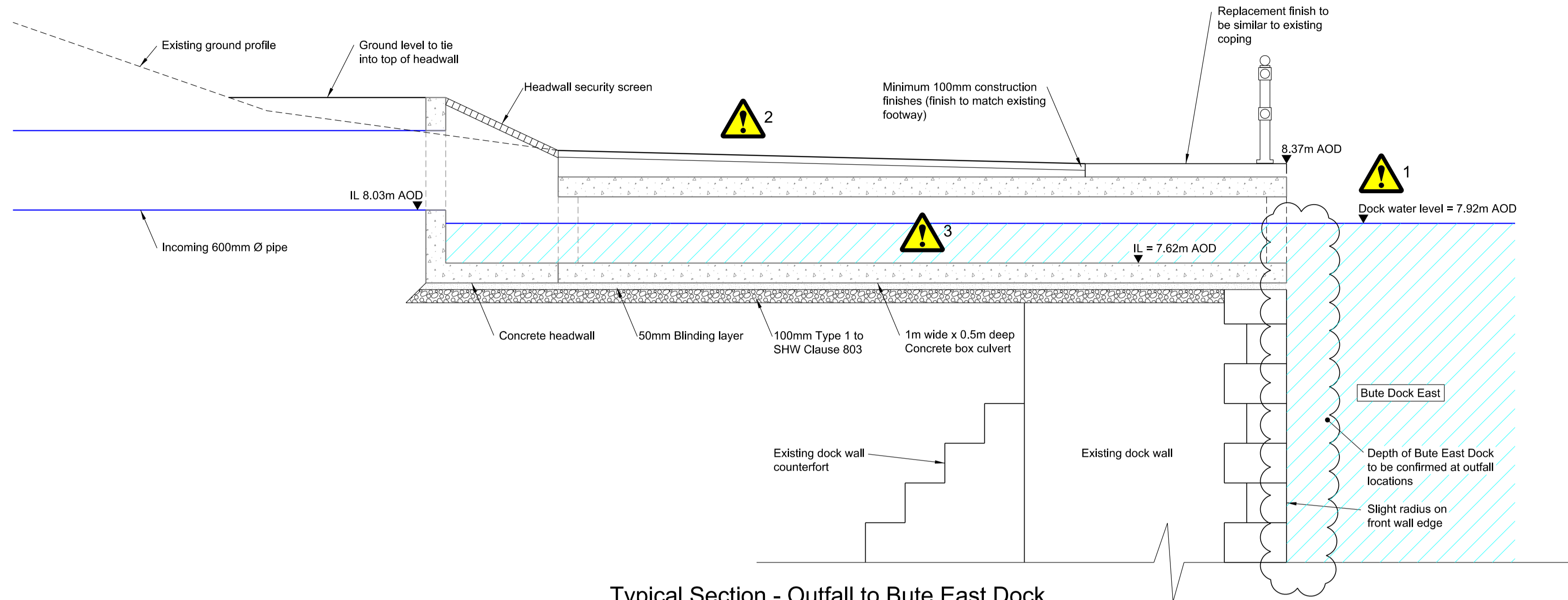

Typical Section - Outfall to Bute East Dock  
1:25

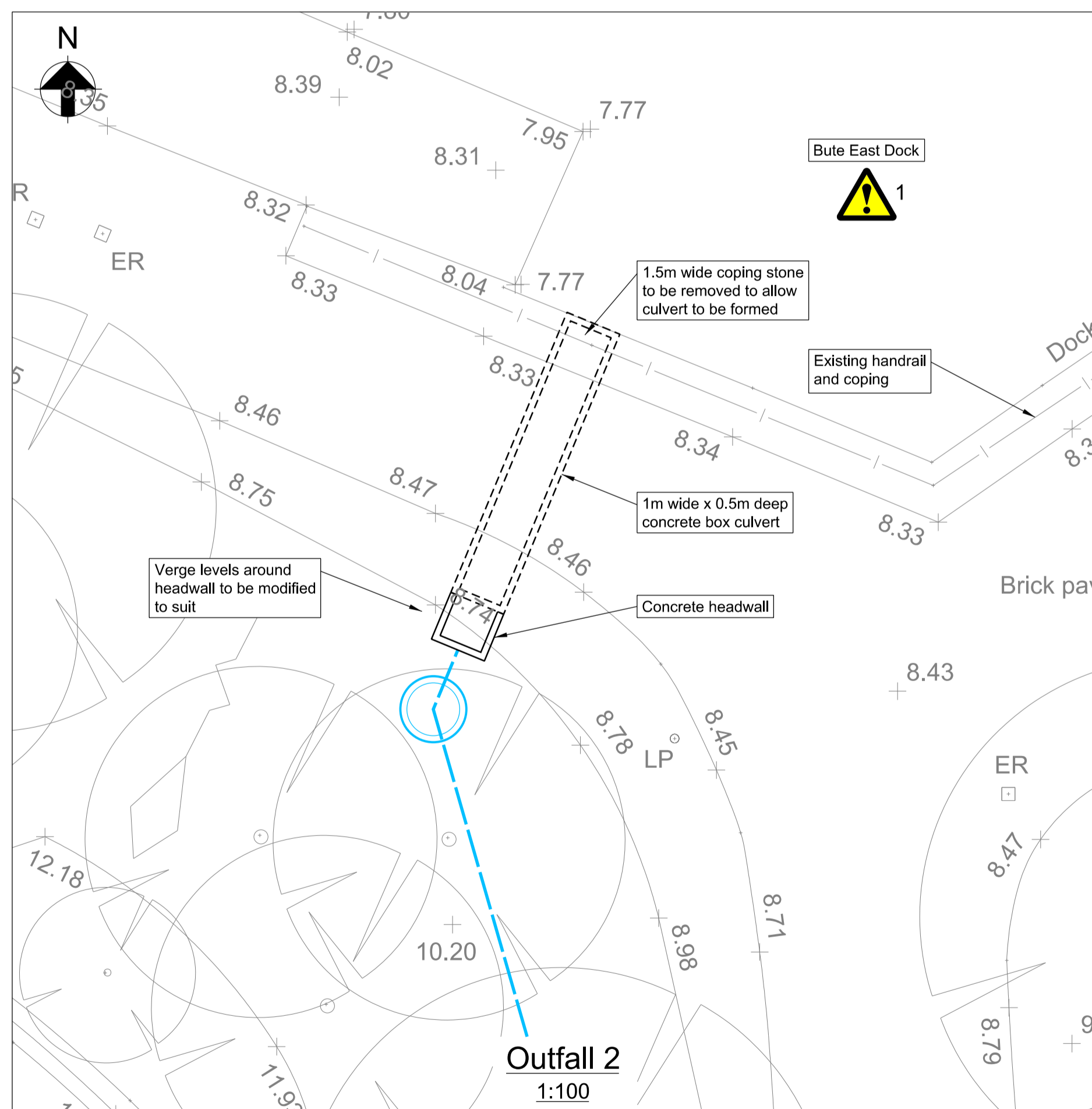
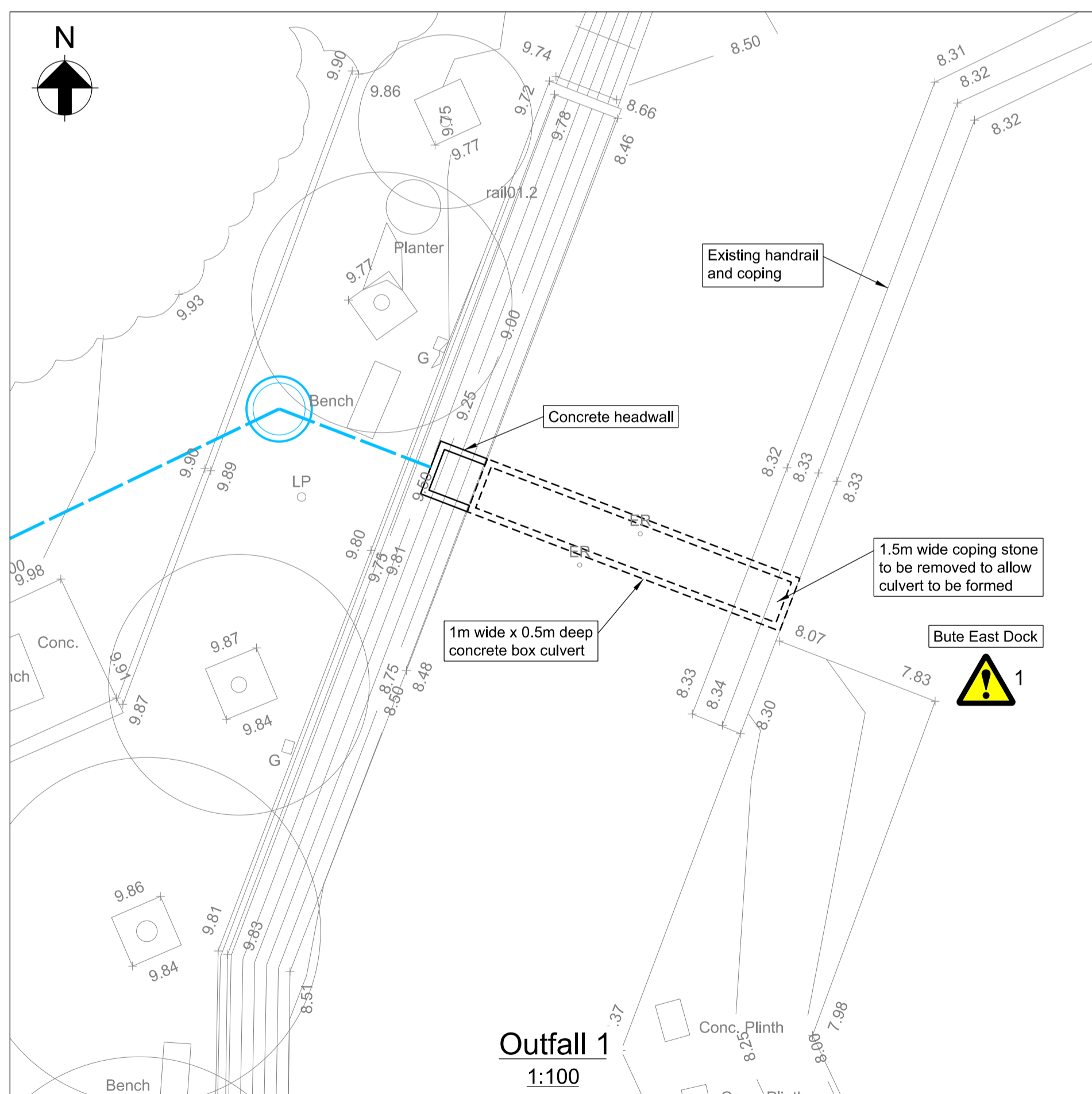

<p><b>Disclaimer</b> Electronic drawings once printed, are uncontrolled and may become out-dated. Refer to CDE for current revision.</p> <p>Do not scale off this drawing; All dimension to be checked on site; All dimension are indicated in millimetres unless otherwise stated. If in doubt ask. © Arup</p> <p><b>Safety, Health and Environmental (S.H.E.) Information Box</b> In addition to the hazards/risks normally associated with the types of work detailed on this drawing, take note of the below. The risks identified below are based on the use of experienced and competent contractors carrying out the work using an approved safe method of working.</p>	<p><b>Construction Risks</b> 1. Working by a water body. 2. Contaminated land</p>	<p><b>Maintenance Risks</b> 3. Confined space working.</p>
	<p><b>Operational Risks</b></p>	<p><b>Demolition / adaptation Risks</b></p>
<p>Notes</p>		

**ARUP**  
4 Pierhead St, Capital Waterside  
Cardiff, CF10 4QP  
T +44(0)29 20473727 F +44(0)29 20472277  
www.arup.com

P01	20/07/21	Issued for Information
Issue	Date	Revision Description
Record of Revisions		

Client  
**ROBERTSON**

Operators  
**LIVE NATION ENTERTAINMENT**  
**OVG OAK VIEW GROUP**

Lead Designer  
**h+k**  
HOK International Ltd.  
Qube, 90 Whitefield Street  
London W11 4EZ United Kingdom  
t +44 (0)20 7636 2006  
f +44 (0)20 7636 1987

Project Title  
**Cardiff Arena & Hotel**

Key Plan

Drawing Title  
**Bute East Dock Outfall Details**

Scale at A1 As Shown		
Role Civil	Drawn By CB	Checked By RW
Approved By JS	Rev P01	
Purpose of Issue Information		
Project No <b>281124</b>		ID <b>CAH-ARP-AX-XX-DR-C-XX-7410</b>